

# SurGuard<sup>®</sup>2 Safety Hypodermic Needle

## Instruction For Use

### INSTRUCTIONS FOR USE

1. Carefully remove the SurGuard2 needle from the package.
2. Securely attach the SurGuard2 needle to a syringe with a push and clockwise twist motion.
3. Move the safety sheath away from the needle and toward the syringe barrel. The safety sheath will remain in the position you set (Fig. 1).
4. Remove the needle cover carefully to avoid damaging the needle.
5. Perform procedure according to established technique.

Note: For user convenience, when the needle is in the "bevel up" position, the sheath is located to the right.

### ACTIVATION:

6. Position sheath in preparation for device activation:

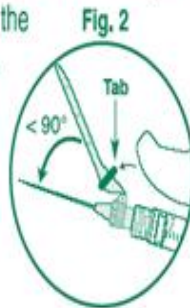

Using a one-handed technique, push the tab forward with your finger or thumb so that the sheath is less than 90 degrees from the needle (Fig. 2). NOTE: Keep your finger or thumb behind the tab at all times.

7. Activate sheath: Position the sheath approximately 45 degrees to flat surface (Fig. 3A). Press down with a **FIRM, QUICK MOTION** until a distinct **AUDIBLE CLICK** is heard (Fig. 3B). **VISUALLY CONFIRM** that the needle is fully engaged under the lock (Fig. 4).

Note: Audible click may not be heard on small needle sizes; visual confirmation is required per Fig. 4.

8. Dispose of used needles and materials following the policies and procedures of your facility as well as federal and local regulations for Sharps disposal.

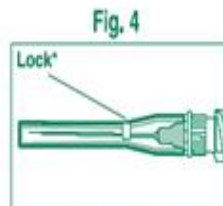
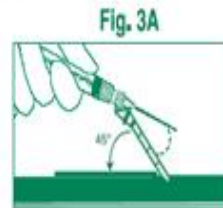

\*Note: the location of the lock will vary depending upon needle size.

# SurGuard®3 Safety Hypodermic Needle

## Instruction For Use (Depends on the product's needle bevel orientation)

### 1.) 0°

#### INSTRUCTIONS FOR USE

##### STEP 1.

Tighten the syringe to the needle using aseptic technique. Grip the base of the needle, not the safety sheath, push and turn the syringe clockwise.

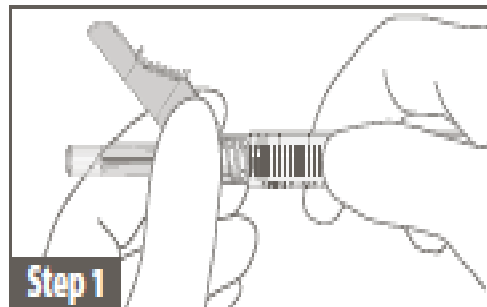

##### STEP 2.

Move the safety sheath away from the needle and toward the syringe barrel to the angle shown, prior to removing the needle cap. Perform injection procedure according to established technique.

(Note: The needle "bevel up" position is oriented to the position of the safety sheath.)

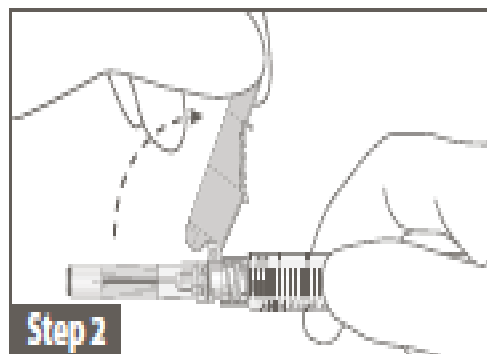

##### STEP 3.

After the injection procedure, use a one-handed technique to activate the safety mechanism using any of the three (3) methods illustrated below.

(Activation is verified by an audible and/or tactile "click", and can be visually confirmed.)

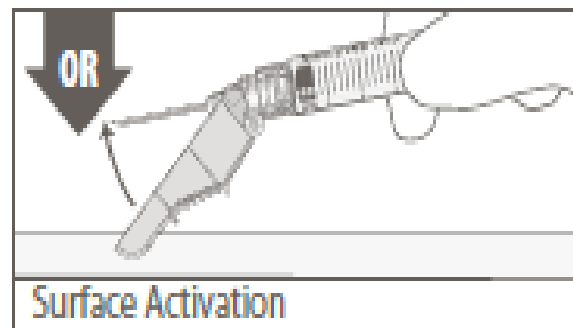
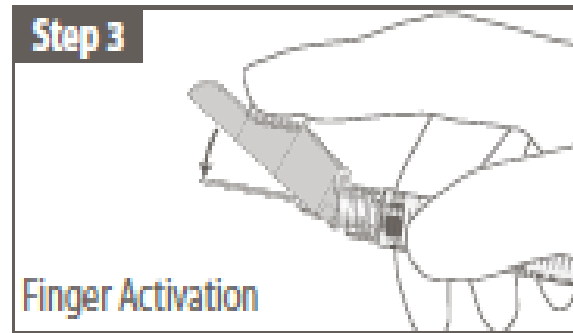

**STEP 4.**

Visually confirm that the safety sheath is fully engaged.

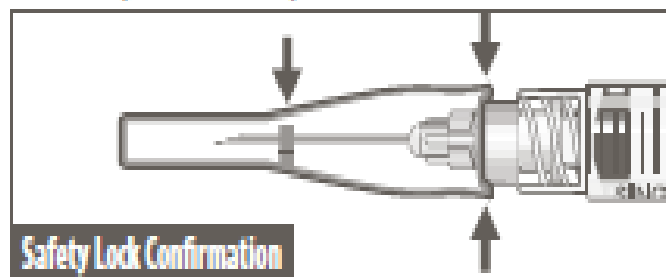

**STEP 5.**

Dispose of used needles and materials following the policies and procedures of your facility as well as federal and local regulations for sharps disposal.

## 2.) 90°

### INSTRUCTIONS FOR USE

#### STEP 1.

Tighten the syringe to the needle using aseptic technique. **Grip the base of the needle, not the safety sheath, push and turn the syringe clockwise.**

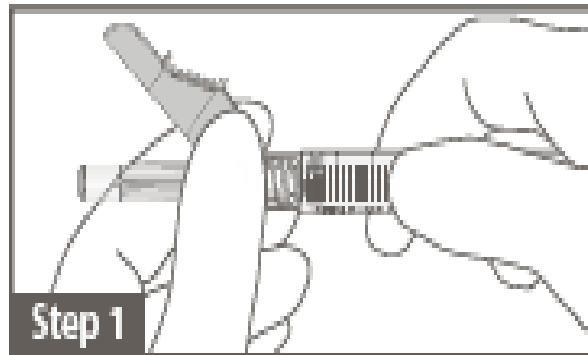

#### STEP 2.

Move the safety sheath away from the needle and toward the syringe barrel to the angle shown, prior to removing the needle cap. Perform injection procedure according to established technique.

(Note: When the needle is in the "bevel up" position, the safety sheath is oriented 90° to the right.)

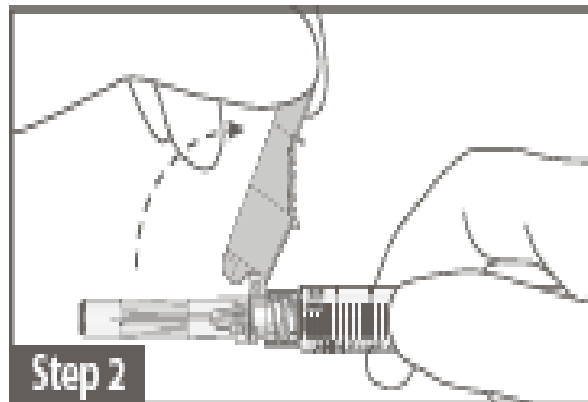

#### STEP 3.

After the injection procedure, use a one-handed technique to activate the safety mechanism using any of the three (3) methods illustrated below.

(Activation is verified by an audible and/or tactile "click", and can be visually confirmed.)

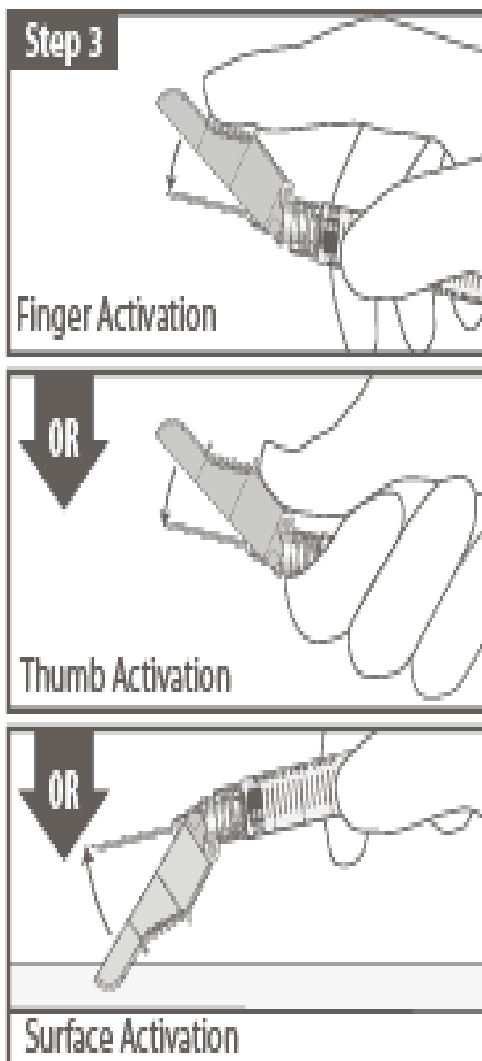

**STEP 4.**

Visually confirm that the safety sheath is fully engaged.

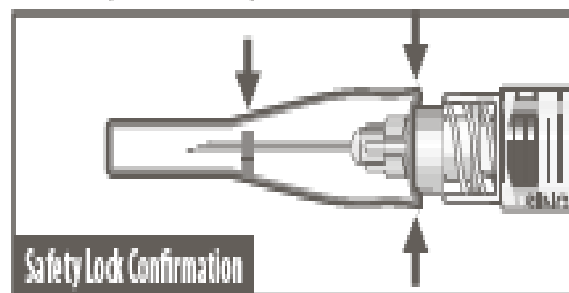

**STEP 5.**

Dispose of used needles and materials following the policies and procedures of your facility as well as federal and local regulations for sharps disposal.